

PLAN NO.

PART	COUNTY	ROUTE	SECTIONS	PROJECT TERMINI		NET LENGTH MILES	
				BEGIN	END		
1	COL	11	11.17	11.17	15.98	4.81	NORTHBOUND
1	COL	11	11.17	11.17	15.98	4.81	SOUTHBOUND

I hereby approve these plans and declare that the making of these improvements will require the closing of the highways to traffic on Parts No. NONE and that detours will be provided by State forces. The closing to traffic of the highways will not be required on Parts No. 1 and provisions for the maintenance and safety of traffic will be as indicated in the proposal.

INDEX OF SHEETS

TITLE SHEET	1
SCHEMATIC PLAN	2-4
TYPICAL SECTIONS	5
GENERAL NOTES	6-7
GENERAL SUMMARY	8
PAVEMENT DATA	9
SHOULDER DATA	10
PAVEMENT PLANING DETAIL	11
TYPICAL MEDIAN CROSSOVER DETAIL	12
WORK ZONE AND PAVEMENT MARKING SUB-SUMMARY	13
RPM SUB-SUMMARY	14

ENGINEERS SEAL:

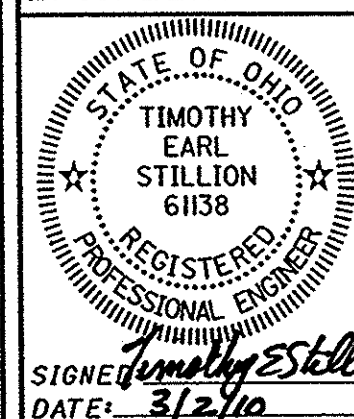

APPROVED _____
DATE 3/2/10

APPROVED
DATE **3-8-10**

Richard A. Buple
DISTRICT DEPUTY DIRECTOR

John M. Malton
DIRECTOR, DEPARTMENT OF TRANSPORTATION

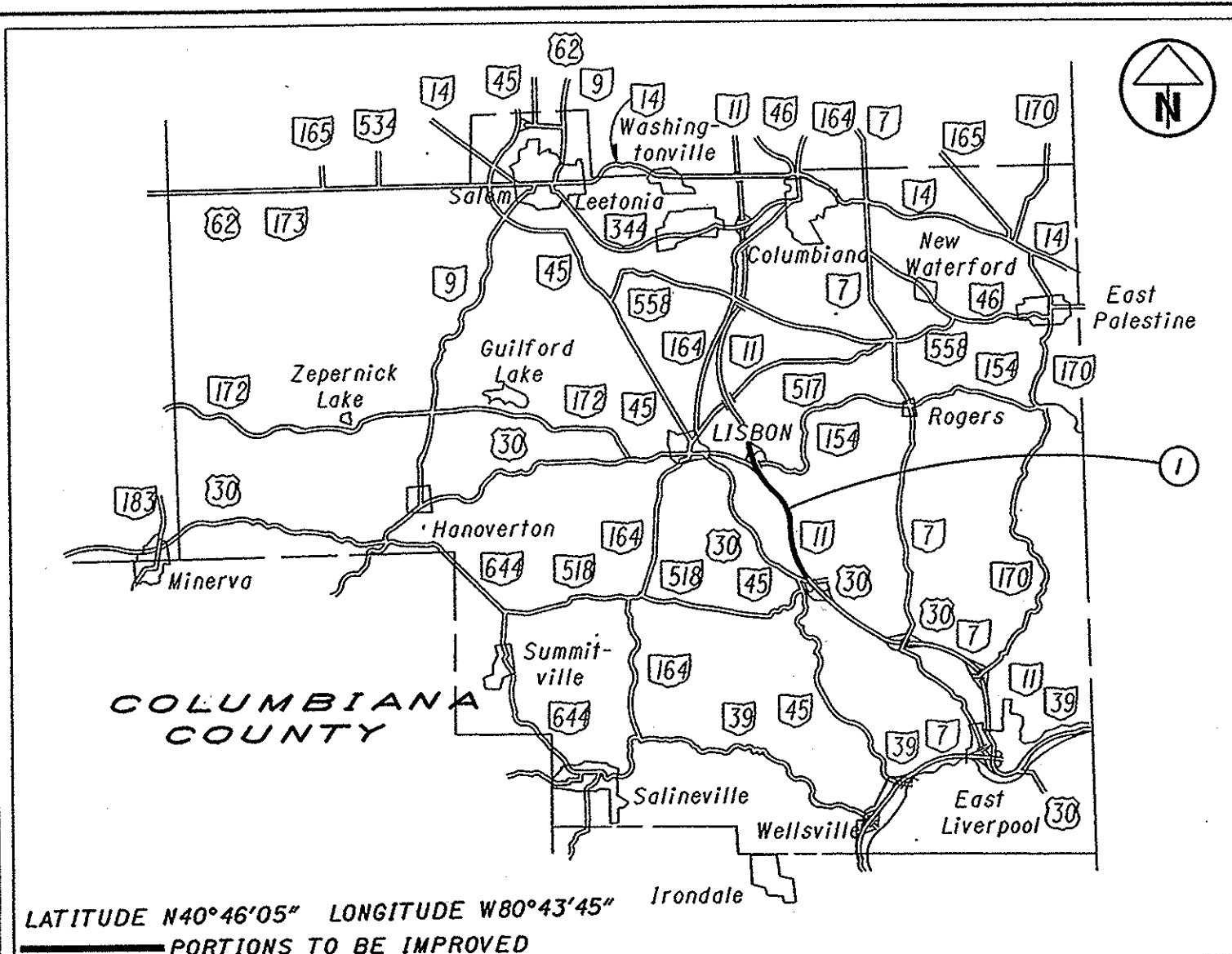

LATITUDE N40°46'05" LONGITUDE W80°43'45" Irondale
 PORTIONS TO BE IMPROVED

UNDERGROUND UTILITIES

**2 WORKING DAYS
BEFORE YOU DIG**
CALL 800-362-2764 (TOLL FREE)
OHIO UTILITIES PROTECTION SERVICE
NON-MEMBERS
MUST BE CALLED DIRECTLY

STANDARD DRAWINGS

				SPECIFICATIONS	
BP-3.1	10-19-07	TC-41.20	1-19-01		
BP-9.1	4-15-05	TC-42.20	7-16-04	800	4-16-10
DM-4.3	4-17-09	TC-52.10	1-19-07	832	5-5-09
DM-4.4	4-17-09	TC-52.20	1-19-07		
		TC-65.10	1-21-05		
MT-35.10	4-20-01	TC-65.11	1-21-05		
MT-95.30	7-17-09	TC-72.20	10-16-09		
MT-98.10	7-17-09	TC-73.10	1-19-01		
MT-98.11	7-17-09				
MT-98.20	7-17-09				
MT-98.22	7-17-09				
MT-99.20	1-16-09				
MT-101.90	1-16-09				
MT-105.10	1-16-09				

SUPPLEMENTAL SPECIFICATIONS

PLAN PREPARED BY
O.D.O.T.
DISTRICT II

COL - SR-11-11.17
100286 PID - 87954
Dist 11 5/27/2010

FEDERAL PROJECT NO.
E100(293)

PID NO. 87954

CONSTRUCTION PROJECT NO.

RAILROAD INVOLVEMENT

NONE

COL-11-11.17

 $\frac{1}{14}$

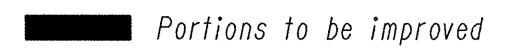

J:\PROJECTS\87954\Prod\Drawings\101.dgn 02-MAR-2010 7:22AM dhoffmal

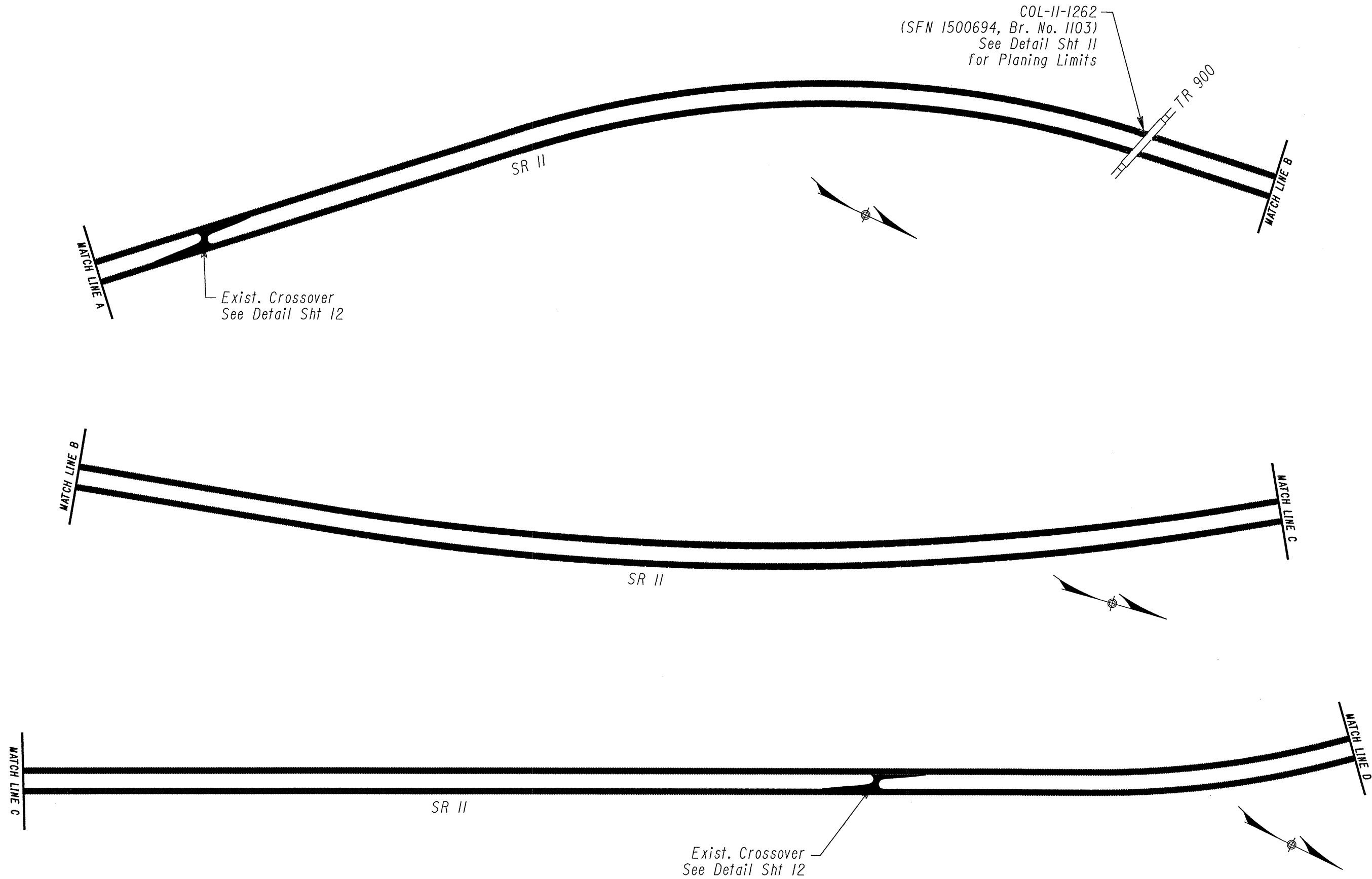

\\B:\PROJECTS\87954\Prod\Drawings\102.dgn 02-MAR-2010 7:23AM dhoffma

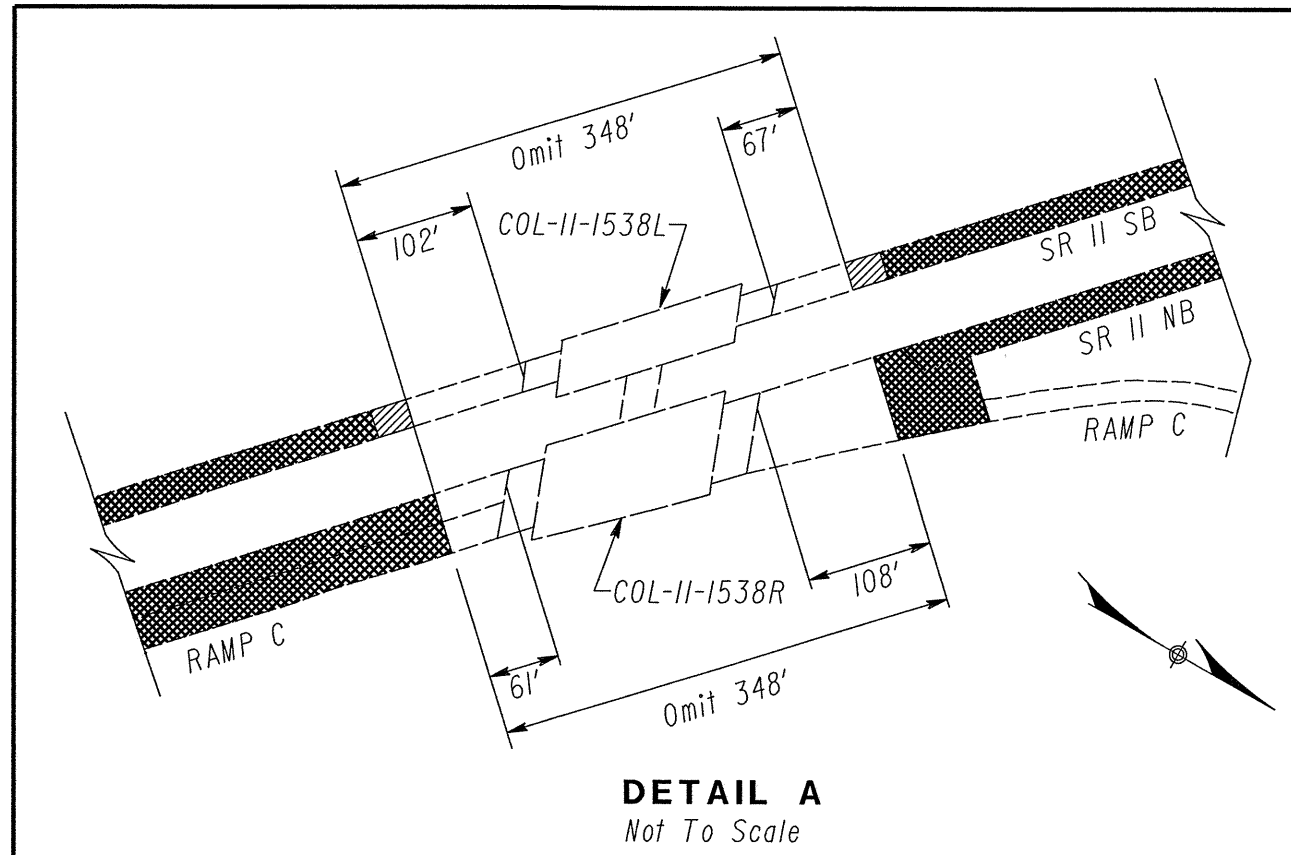
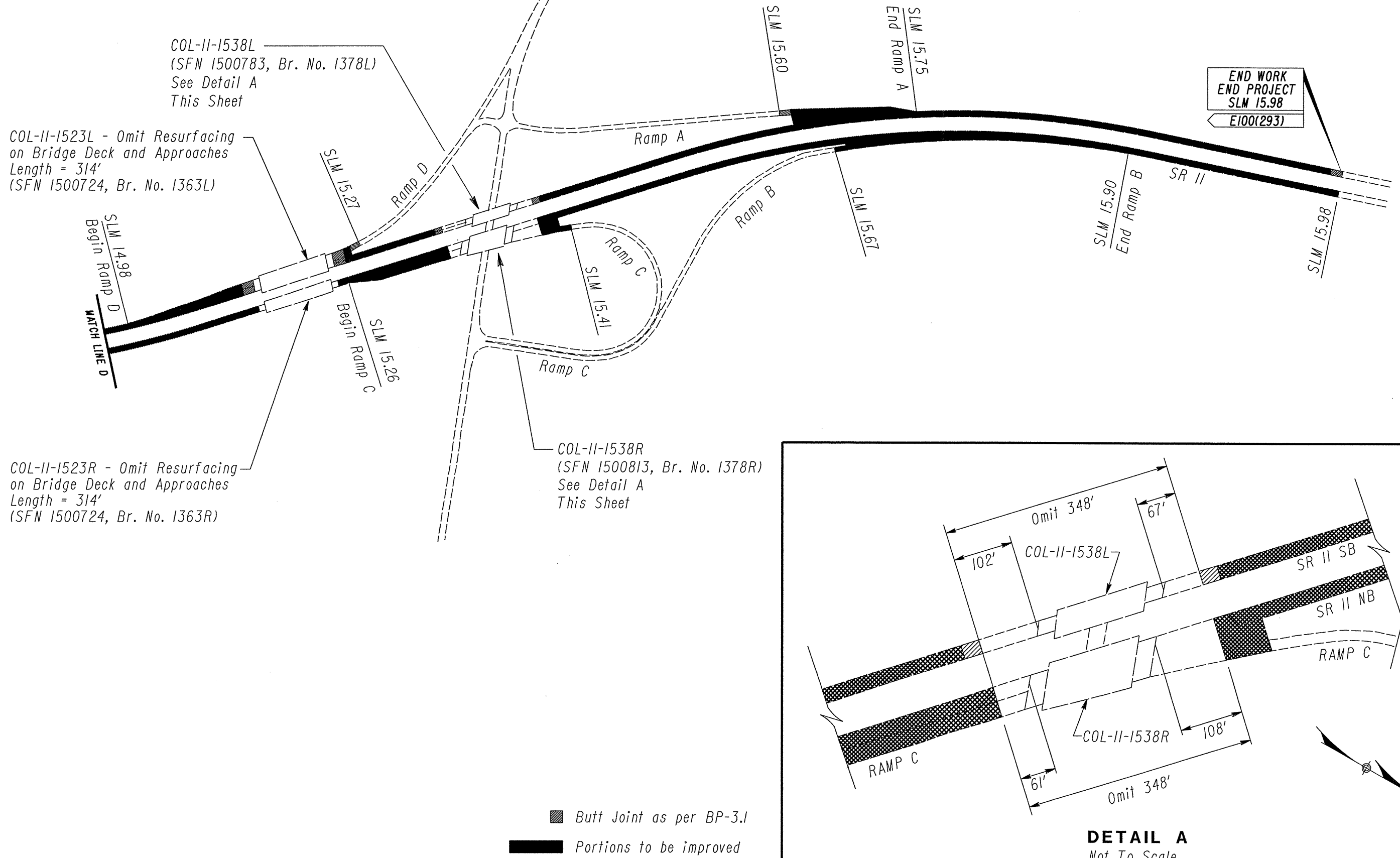

CALCULATED
DAH
CHECKED
TES

SCHEMATIC PLAN

COL-11-11.17

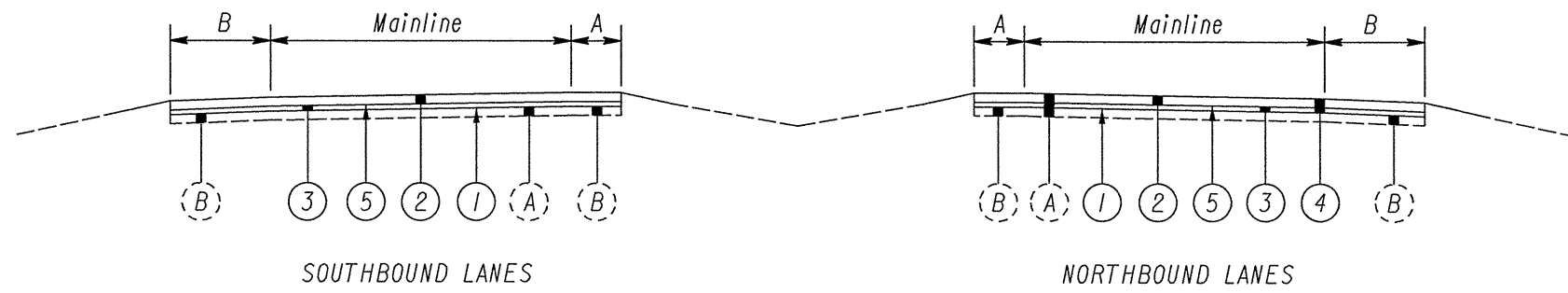

TYPICAL I

LEGEND

- ① — Item 407 - Tack Coat (0.075 Gal/S.Y.)
- ② — Item 442 - 1½" Asphalt Concrete Surface Course, 12.5MM, Type B (448), As Per Plan
- ③ — Item 448 - ½" Asphalt Concrete Intermediate Course, Type I, PG64-22 (Spot Leveling)
- ④ — Item 254 - 1¼" Pavement Planing, Asphalt Concrete
- ⑤ — Item 407 - Tack Coat for Intermediate Course (0.04 Gal/S.Y.)
- (A) — Existing Asphalt Concrete
- (B) — Existing Paved Shoulder

PROFILE AND ALIGNMENT

The proposed pavement resurfacing shall follow the Alignment and Profile of the existing pavement. The proposed asphalt concrete overlay shall have a uniform surface course thickness and varying intermediate course thickness as shown on the pavement data sheets.

SURFACE COURSE COMPLETION REQUIREMENTS

Any given length of work on which resurfacing operations have been started in a construction season shall have the surface course placed that same season.

ITEM 614 - MAINTAINING TRAFFIC

Traffic shall be maintained at all times as described below and in accordance with the specifications of Item 614 and the Ohio Manual of Uniform Traffic Control Devices. The length of restricted traffic zones shall be kept to a minimum. When raised pavement markers are to be installed the required lane closure shall remain in effect until the epoxy is dry and all foreign matter or debris created by the installation of the RPM casting is removed from the roadway.

At least one lane of traffic shall be maintained in each direction at all times as per Standard Construction Drawing MT-95.30.

Construction work shall be permitted on only one side of the directional roadway at a time and any open pavement trench shall be adequately maintained and protected with barricades, drums or vertical panels. Under no circumstances shall the Contractor be permitted to have work zones that alternately close both the passing lane and the travel lane unless the distance between the lane restrictions exceeds two (2) miles.

Ramp traffic shall be maintained by use of portions of the existing and/or resurfaced pavement and existing shoulders.

However, in no case shall traffic be permitted to form a queue which extends beyond the limits of the ramp onto the speed change lane, mainline or crossroad pavement. The limits and duration of any traffic stoppage shall at all times be subject to the direction of the Engineer.

All planed surfaces shall be resurfaced prior to the lane reopening for use by traffic.

ITEM 614 - MAINTAINING TRAFFIC (CONTINUED)

No work shall be performed and all existing lanes shall be open to traffic during the following designated holidays or events:

Memorial Day
Fourth of July
Labor Day

The period of time that the lanes are to be open depends on the day of the week on which the holiday or event falls. The following schedule shall be used to determine this period:

Day of the Week	Time all lanes must be open to traffic
Sunday	12:00n Friday through 6:00 am Monday
Monday	12:00n Friday through 6:00 am Tuesday
Tuesday	12:00n Monday through 6:00 am Wednesday
Wednesday	12:00n Tuesday through 6:00 am Thursday
Thursday	12:00n Wednesday through 6:00am Monday
Friday	12:00n Thursday through 6:00 am Monday
Saturday	12:00n Friday through 6:00 am Monday

No extensions of time shall be granted for delays in material deliveries, unless such delays are industry-wide, or for labor strikes, unless such strikes are area wide. Should the contractor fail to meet any of these requirements, the contractor shall be assessed liquidated damages in accordance with CMS 108.07.

All work and traffic control devices shall be in accordance with CMS 614 and other applicable portions of the specifications, as well as the Ohio Manual of Uniform Traffic Control Devices. Payment for all labor, equipment and materials shall be included in the lump sum contract price for Item 614, Maintaining Traffic, unless separately itemized in the plan.

GRINDINGS FROM PLANING OPERATIONS

The grindings shall become the property of the Contractor and be disposed of at his expense outside of the limits of Right of Way.

ITEM 442- ASPHALT CONCRETE SURFACE COURSE, 12.5 MM, TYPE B (448), AS PER PLAN

Materials furnished for fine and coarse aggregates used in this item shall exclude all stone and crushed carbonate stone.

ITEM 642 - TRAFFIC PAINT

The Contractor shall replace the existing pavement markings within the project limits with new pavement markings at the same locations per 641.06. See Standard Drawings TC-72.20 and TC-73.10 for pavement marking details.

CONTRACTOR'S EQUIPMENT - OPERATION AND STORAGE

The Contractor's equipment shall be operated in the direction of traffic. A qualified Flagger shall be employed where the Contractor's equipment must merge with the traffic stream. The Contractor's equipment shall be equipped with at least one (1) amber flashing light. Pavers, rollers and other equipment may be parked in areas along the highway when or paving operations are scheduled to occur within the next workday; otherwise the equipment shall be stored at a storage area, the location of which shall have prior approval of the Engineer. When parking along the highway, the equipment shall be parked either thirty (30) feet from the outside edge of pavement or six (6) feet behind guardrail with a minimum of 120 feet of guardrail preceding the equipment. All other equipment, including private vehicles, shall be stored at the approved Contractor's storage area.

The Contractor shall designate an individual, other than the Superintendent and subject to the approval of the Engineer, to continuously inspect all traffic control devices whenever construction work is being performed within the work limits of the project. The designated individual shall also inspect all traffic control devices at the end of each work day. The designated individual shall also be available on an around-the-clock basis to repair and/or replace damaged or missing traffic control devices. Payment for the Traffic Control Inspector shall be included in the lump sum price bid for Item 614 - Maintaining Traffic.

ITEM 614 - LAW ENFORCEMENT OFFICER WITH PATROL CAR FOR ASSISTANCE

Use of Law Enforcement Officers (LEOs) by contractors other than the uses specified below will not be permitted at project cost. LEOs should not be used where the OMUTCD intends that flaggers be used.

In addition to the requirements of CMS 614 and the Ohio Manual of Uniform Traffic Control Devices (OMUTCD), a uniformed law enforcement officer and official patrol car with working top-mounted emergency flashing lights shall be provided for controlling traffic for the following tasks:

For lane closures: during initial set-up periods, tear down periods, substantial shifts of a closure point or when new lane closure arrangements are initiated.

LEOs should not forgo their traffic control responsibilities to apprehend motorists for routine traffic violations. However, if a motorist's actions are considered to be reckless, then pursuit of the motorist is appropriate.

The LEOs work at the direction of the Contractor. The Contractor is responsible for securing the services of the LEOs with the appropriate agencies and communicating the intentions of the plans with respect to duties of the LEOs. The Engineer shall have final control over the LEOs' duties and placement, and will resolve any issues that may arise between the two parties.

The LEO shall report in to the Contractor prior to the start of the shift, in order to receive instructions regarding specific work assignments during his/her shift. The LEO is expected to stay at the project site for the entire duration of his/her shift. The LEO shall report to the Contractor at the end of his/her shift. Once the LEO has completed the duties described above and still has time remaing on his/her shift, the LEO may be asked to patrol through the work zone (with flashing lights off) or be placed at a location to deter motorists from speeding. Should it be necessary to leave the project site, the LEO shall notify the Engineer. The contractor shall provide the LEO with a two-way communication device which shall be returned to the Contractor at the end of his/her shift.

ITEM 614 - LAW ENFORCEMENT OFFICER WITH PATROL CAR FOR ASSISTANCE (CONTINUED)

LEOs (with patrol car) required by the traffic maintenance tasks above shall be paid for on a unit price (hourly) basis under Item 614, Law Enforcement Officer (With Patrol Car) for Assistance. The following estimated quantities have been carried to the general summary.

Item 614, Law Enforcement Officer With Patrol Car for Assistance - 40 hours

The hours paid shall include any minimum show-up time required by the law enforcement agency involved.

Any additional costs incurred by the Contractor to obtain the services of an LEO are included with the bid unit price for Item 614, Law Enforcement Officer with Patrol Car for Assistance.

NOTIFICATION OF WORK ZONE LANE RESTRICTIONS

The Contractor shall notify the Engineer at least eighteen (18) days prior to implementing any work zone restrictions that will reduce the width or vertical clearance of any lane on which traffic will be maintained during construction.

The Engineer shall immediately notify the District Roadway Services Manager to advise the Office of Highway Management of the restrictions.

ITEM 614 - WORK ZONE MARKINGS AND SIGNS

The following estimated quantity has been carried to the General Summary for use as directed by the Engineer for Work Zone Marking Signs per the requirements of 614.04 and 614.11.

Item 614 - Work Zone Marking Sign 12 Each

J:\PROJECTS\87954\Prod\Dan\00.dgn 02-MAR-2010 7:30AM dhoffmal

[illegible]

<div style="border: 1px solid black; border-radius: 50%; width: 40px; height: 40px; display: flex; align-items: center; justify-content: center; margin: 0 auto;"> <div style="writing-mode: vertical-rl; transform: rotate(180deg);">9</div> <div style="writing-mode: vertical-rl; transform: rotate(180deg);">14</div> </div>	COL-11-11.17	<div style="text-align: center; padding: 10px;"> PAVEMENT DATA </div>	CALCULATED
			DAH
			CHECKED
			TES

<div style="border: 1px solid black; border-radius: 50%; width: 40px; height: 40px; display: flex; align-items: center; justify-content: center; margin: 0 auto;"> <div style="width: 10px; height: 10px; border-radius: 50%; background-color: black; margin-right: 5px;"></div> <div style="text-align: center;"> <div style="border-bottom: 1px solid black; width: 100%;">10</div> <div style="border-bottom: 1px solid black; width: 100%;">14</div> </div> </div>	COL-11-11.17	SHOULDER DATA		
		CALCULATED		
		DAH	CHECKED	
		TES		



J:\PROJECTS\87954\Prod\Dan\ga101.dgn 02-MAR-2010 7:38AM dhoffmal

SR II NB

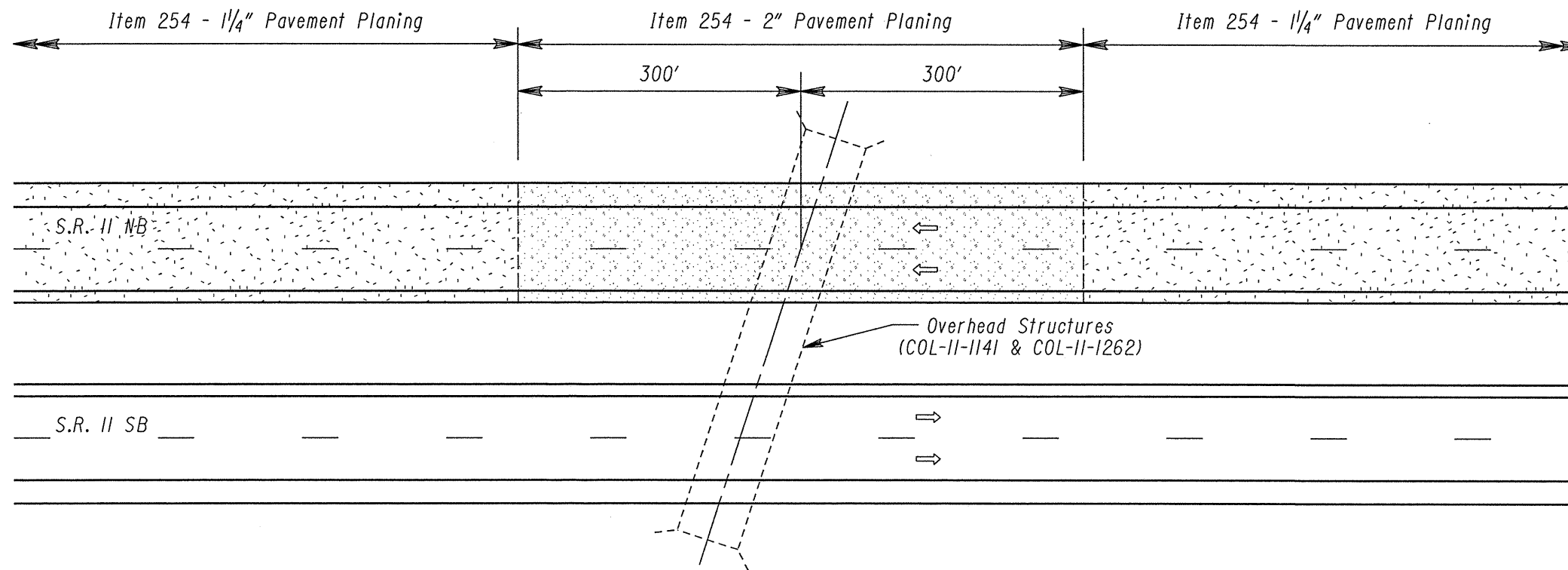
Planing in northbound lanes calculated on Pavement Data Sheet 9 for the entire length of the project.



MAINLINE PAVEMENT PLANING DETAIL

-  Item 254 - 1 1/4" Pavement Planing
-  Item 254 - 2" Pavement Planing

J:\PROJECTS\887954\Prod\Dgn\gal02.dgn 02-MAR-2010 7:38AM dhoffml

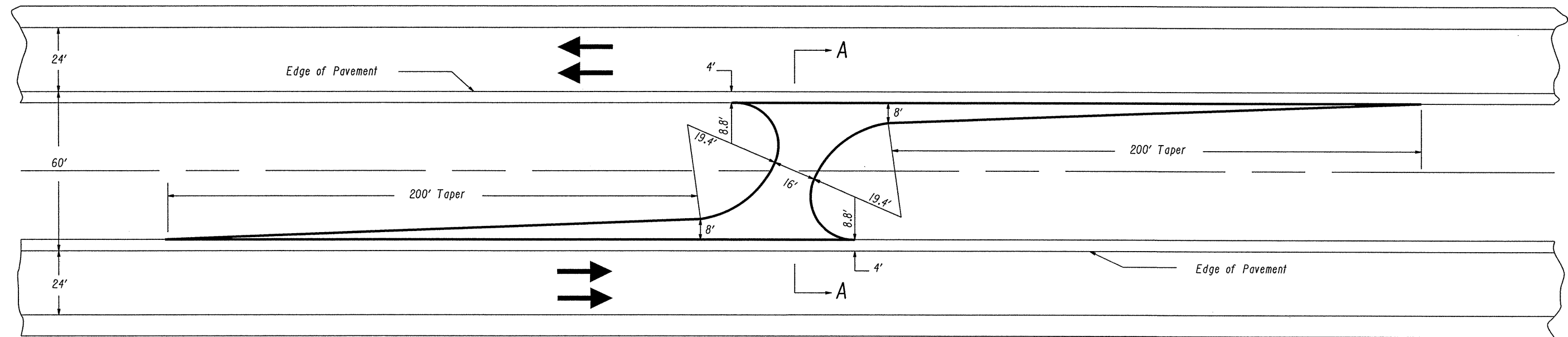

PLAN
(Not to Scale)

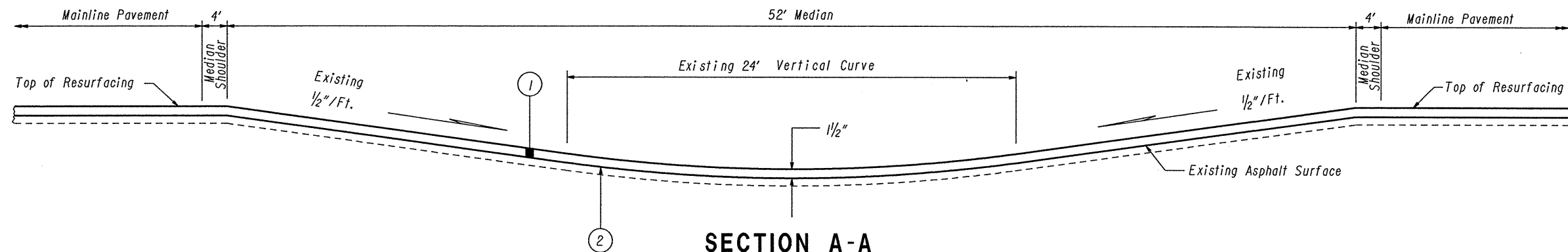

SECTION A-A
(Not to Scale)

LEGEND

- ① — Item 442, 1 1/2" Asphalt Concrete Surface Course, 12.5 MM, Type B (448), As Per Plan
- ② — Item 407, Tack Coat (0.075 gal/sq.yd.)

CALCULATIONS

Planimetered Area = 793.21 Sq. Ft.

Item 407: $793.21 \text{ Sq. Ft.} \div 9 \times 0.075 \text{ Gal/Sq. Yd.} \times 2 \text{ locations} = 13.2 \text{ Gal.}$
Use 13 Gal.

Item 442: $793.21 \text{ Sq. Ft.} \times 1.5" \div 12 \div 27 \times 2 \text{ locations} = 7.3 \text{ Cu. Yd.}$
Use 7 Cu. Yd.

(Quantities Carried to General Summary)

CALCULATED
DAH
CHECKED
TES

TYPICAL MEDIAN CROSSOVER DETAIL

COL-11-11.17

12
14

